

RICHFIELD TOWNSHIP PARK CAMPGROUND MAP

SECTIONS 23 & 26, T23N, R11W, RICHFIELD TOWNSHIP
ROSCOMMON COUNTY, MICHIGAN

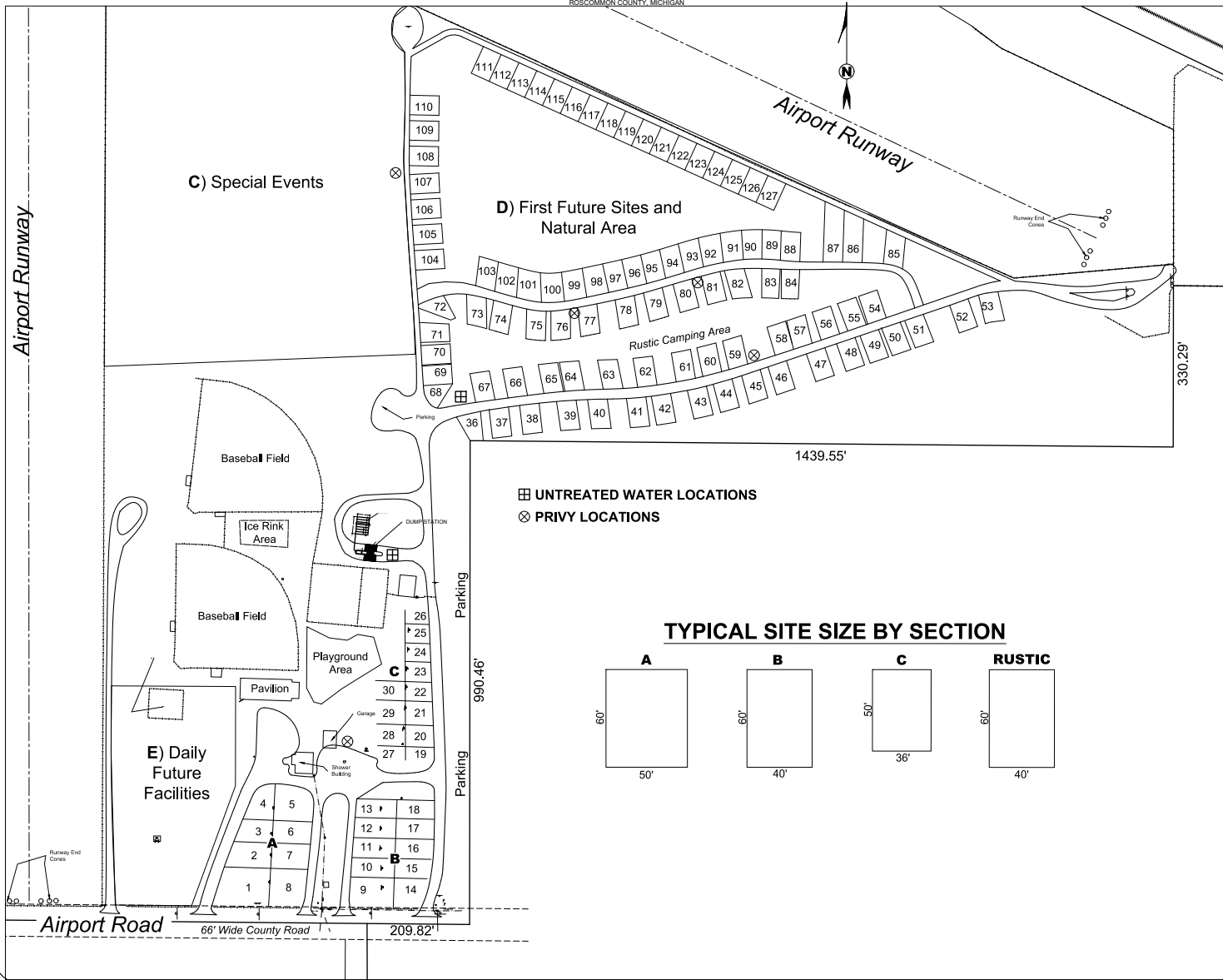

 UNTREATED WATER LOCATIONS
 PRIVY LOCATIONS

TYPICAL SITE SIZE BY SECTION

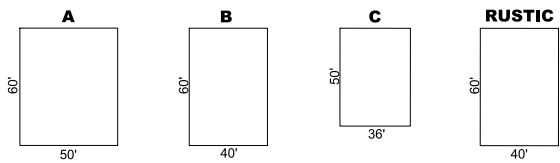

RICHFIELD TOWNSHIP PARK

LEGEND

- | | |
|--|---|
| <ul style="list-style-type: none"> SQUARE CATCH BASIN LIGHT POLE TELE PEDESTAL UTILITY POLE SIGN WELL RAILROAD SIGNAL WATER SPICKET HYDRANT ROUND CATCH BASIN SANITARY MANHOLE MANHOLE | <ul style="list-style-type: none"> GOVERNMENT CORNER BENCHMARK TREE FOUND CONCRETE MONUMENT MISS DIG TELEPHONE MARKER MISS DIG ELECTRIC MARKER MISS DIG GAS MARKER BURIED GAS LINE MARKER BURIED GAS LINE MARKER OVERHEAD UTILITY LINE FENCE LINE ELECTRIC OUTLET BOX |
|--|---|

PARCEL INFORMATION:

Existing Areas:
 ± 134.75 Acres Total
 ± 15 South of Airport Road
 ± 5.8 Used by Compost Area
 ± 50.1 Used by Airport
 ± 6.9 Used for Rustic Camping
 ± 2.8 Used for Modern Camping
 ± 6.2 Used for Sports and Playgrounds

Future Development Areas:
 A) ± 11.29 Acres
 B) ± 18.71 Acres
 C) ± 10.43 Acres
 D) ± 9.22 Acres
 E) ± 2.34 Acres



RICHFIELD TOWNSHIP PARK MAP SECTION 23 & 26, T23N, R11W, RICHFIELD TOWNSHIP ROSCOMMON COUNTY, MICHIGAN

I, John P. May, hereby certify to Richfield Township, that on December 11, 2014, I have mapped the described property and that the error of closure is less than 1 in 5000.

John P. May, P.S. ORIGINAL SIGNATURE IN BLUE
Professional Surveyor No. 43061

Prepared For:
Richfield Township
James VannWormer, Supervisor
P.O. Box 128
St. Helen, Michigan 48656

OFFICIAL SEAL

May & Associates, Inc.
[surveyors]
3107 W. WOODBINE ST.
West Branch, Michigan 48661
Tel: (989) 345-1000
Fax: (989) 345-1100
©2014 MAY & ASSOCIATES, INC.
www.mayandassociates.com

DATE: March 20, 2015	PAGE: SHEET 1 OF 3
SCALE: 1" = 100'	REVISED:
DWG NO: S14B05A	DRAWN BY: TRC
CLIENT: JOB Richfield S14B05A	CHECKED: TRC